

CUBE

HIGH PARTITION



DESIGN
EXPLANATION OF
WALL STORAGE SERIES

Office space is the workplace, but also the employees' living space. Modern enterprises pay more attention to humane working environment, and fit into the corporate philosophy to the decoration. High compartment can be easily combined with the construction of the wall, creating a closed or open space, visual permeability and sound isolation on the flexible adjustment, is to create humane ideal solution for office space.

VICTORY CUBE wall high compartment and high wall cabinet products provide support for the ideal office space, its modular structure reduce the construction period while still ensuring quality. There are a full range of product sizes, a variety of options and flexible plate connections. It can be adapted to any building structure, build your expectations decoration style and space layout, and to facilitate future changes and upgrades for the spatial layout.





p wall system, so that the whole uniform space as a whole, while acting as walls and storage cabinets, repeat the input space and cost - saving, high price / performance.







As an office wall, it creates acoustically and visually protected areas.



The design wins over with svelte elegance and clear outlines, and it can be specified in a wide range of materials and panel sizes.





Used as a corridor wall, it enables transparency and lets daylight into central areas.





Different designs and materials can be applied to each side of the office wall, facilitating the integration of several organization and storage elements.



Spare parts with various functions
available for adopting.





---分段尺寸

分级原则说明：

- 1、H表示柜高、W表示柜宽、D表示柜深、H1至H6表示分级高度；
- 2、H1、H2取值满足条件：
 $H1、H2=N*32+4.5$ ；
- 3、H3、H4、H5、H6取值满足条件：
 $H3、H4、H5、H6=N*32$ ；
- 4、带抽屉柜（如CBQG11）常规H2取值为964.5；H1建议取值为2180.5
- 5、分一级时：
 $H \leq 2480$ （MFC），
 $H \leq 2780$ （实木）。

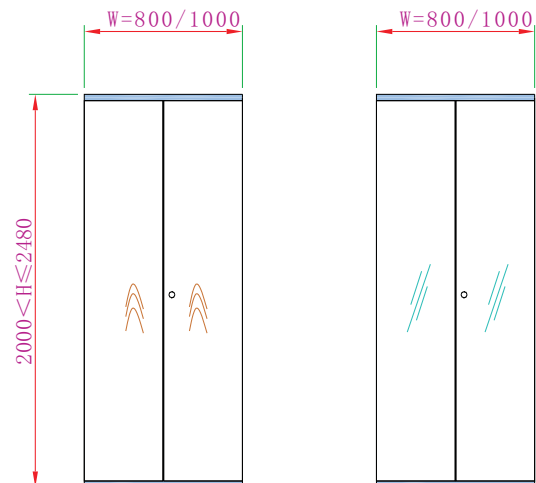

功能柜（CUQG01）
-单/双开木门

功能柜（CUQG01）
-单/双玻璃门

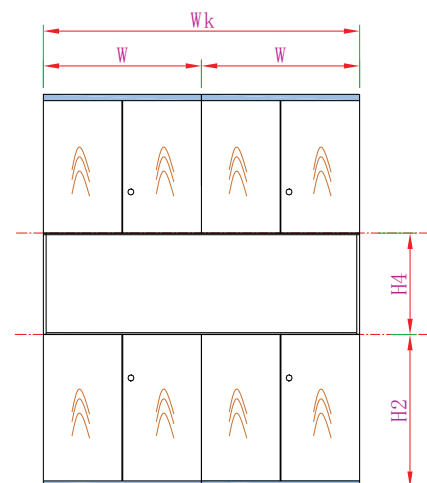

大空格柜（CUQG24）-双开木门

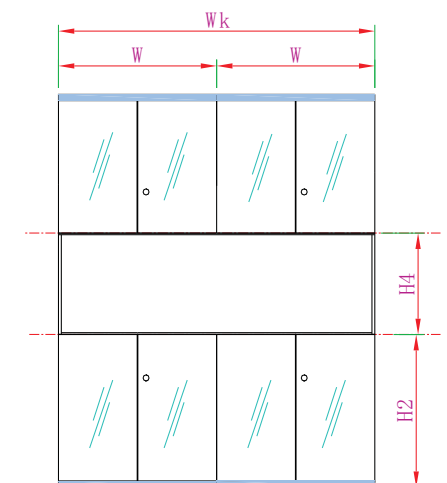

大空格柜（CUQG24）-双开玻璃门

二分段--- $2480 \leq H \leq 3200$

注：消防柜内面用红色防火板

分段形式-A

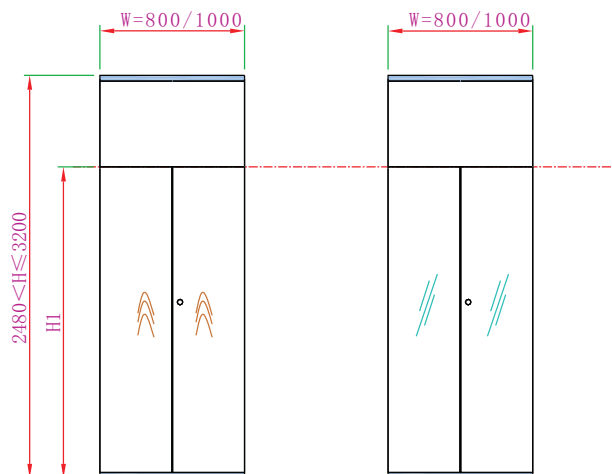

功能柜 (CUQG02)
-双开木门

功能柜 (CUQG02)
-双开玻璃门

分段形式-B

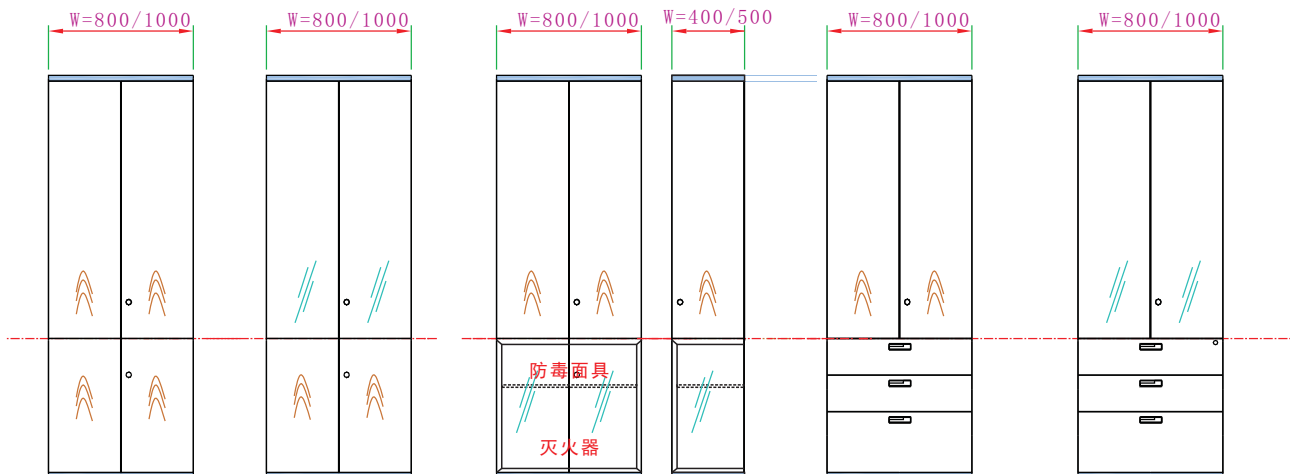

层板柜 (CUQG10)
-双开木门

层板柜 (CUQG10)
-双开玻璃门

消防柜
-双开木门

消防柜
-单开木门

层板柜 (CUQG11)
-带抽双开木门

层板柜 (CUQG11)
-带抽双玻璃门

分段形式-C

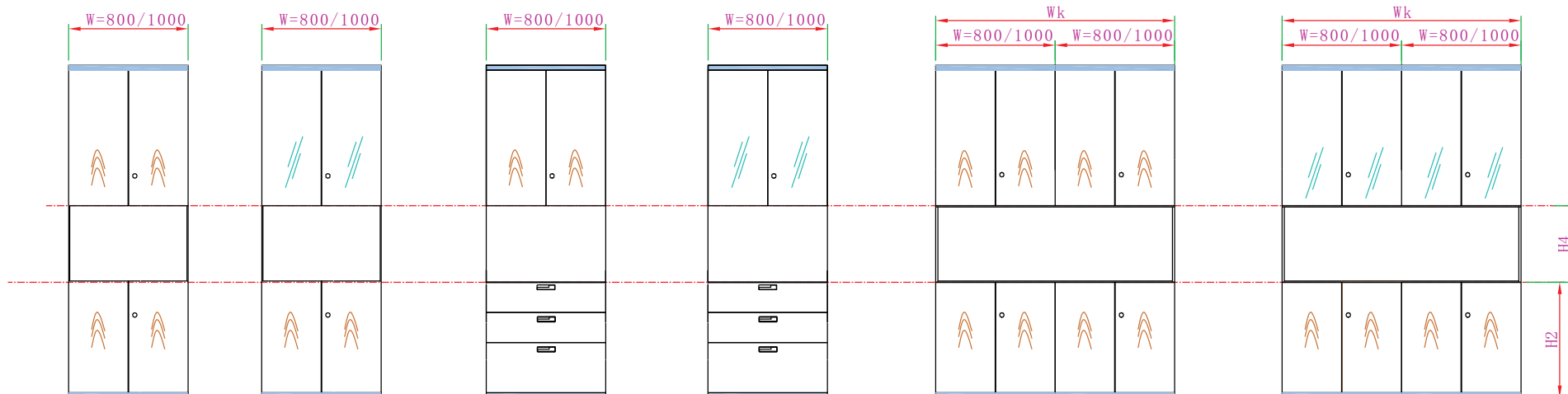

小空格柜 (CUQG21)
-双开木门

小空格柜 (CUQG21)
-双开玻璃门

小空格柜 (CUQG23)
-带抽双开木门

小空格柜 (CUQG23)
-带抽双开玻璃门

大空格柜 (CUQG24)
-双开木门

大空格柜 (CUQG24)
-双开玻璃门

三分段--- $2480 \leq H \leq 3200$

分段形式-A

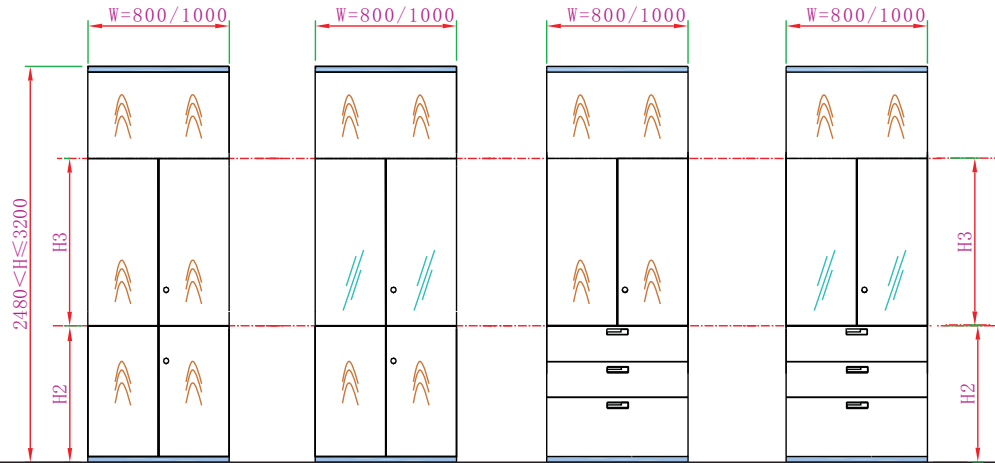

层板柜(CUQG13)
-双开木门

层板柜(CUQG13)
-双开玻璃门

层板柜(CUQG12)
-带抽双开木门

层板柜(CUQG12)
-带抽双开玻璃门

分段形式-B

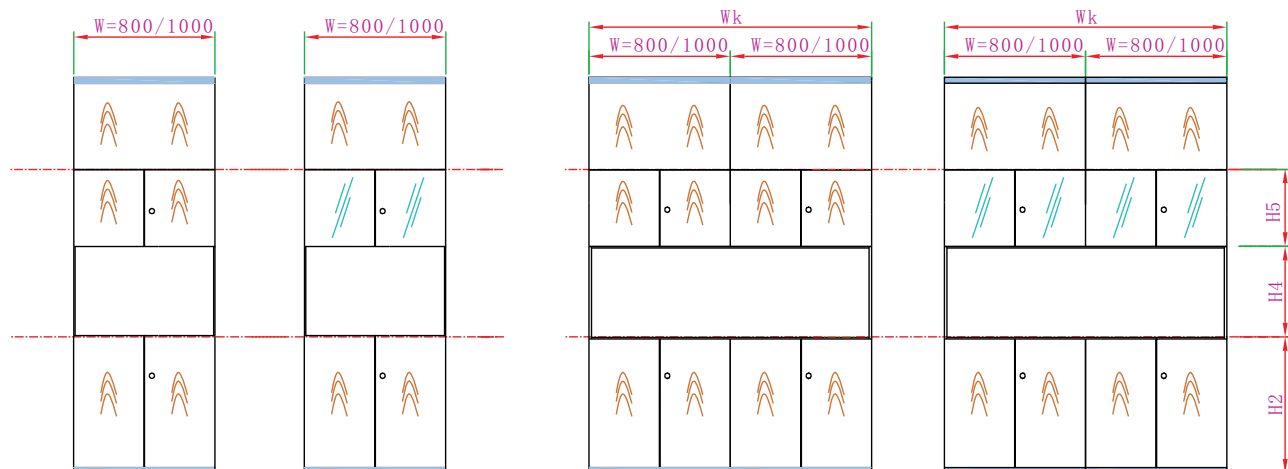

小空格柜(CUQG22)
-单开木门

小空格柜(CUQG22)
-单开玻璃门

大空格柜(CUQG25)
-双开木门

大空格柜(CUQG25)
-双开玻璃门

分段形式-C

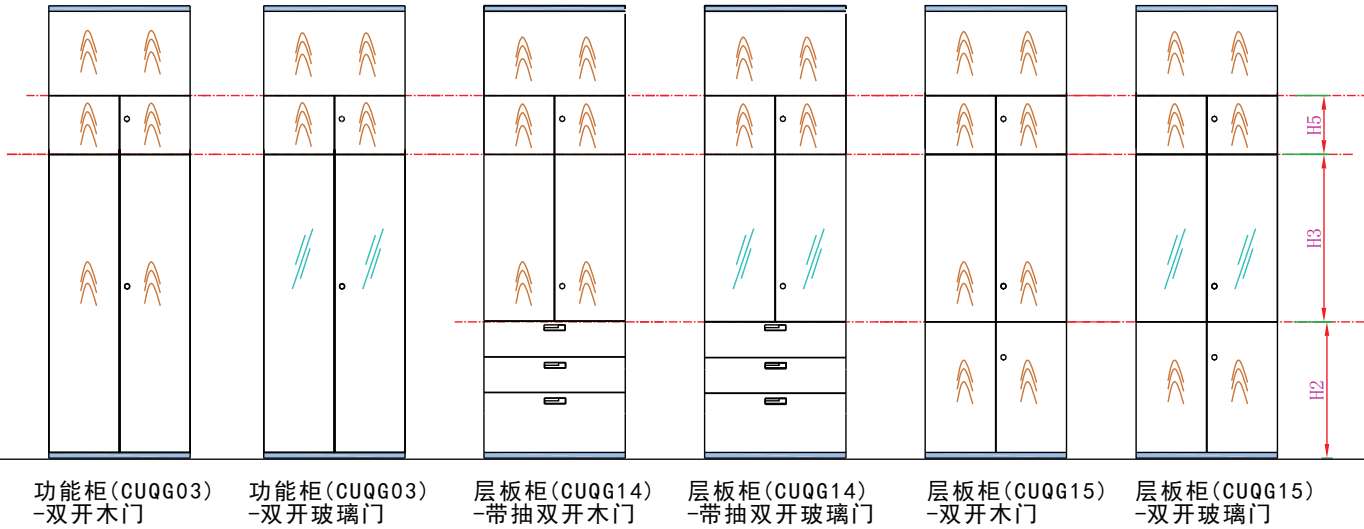

分段形式-D

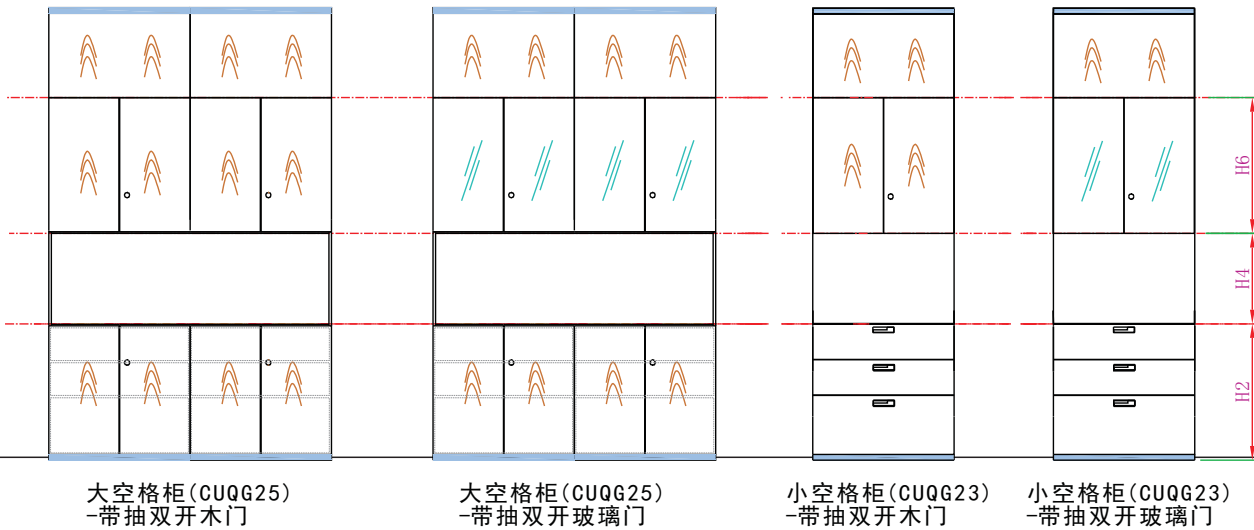

----门板

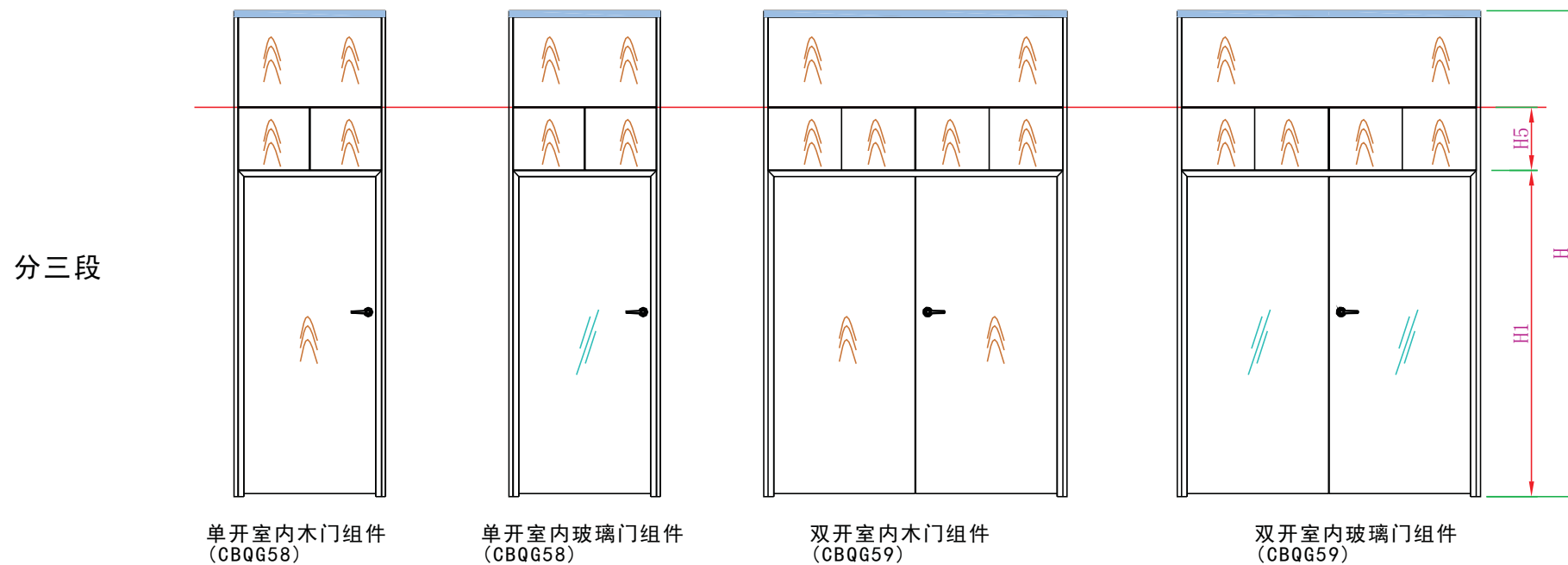
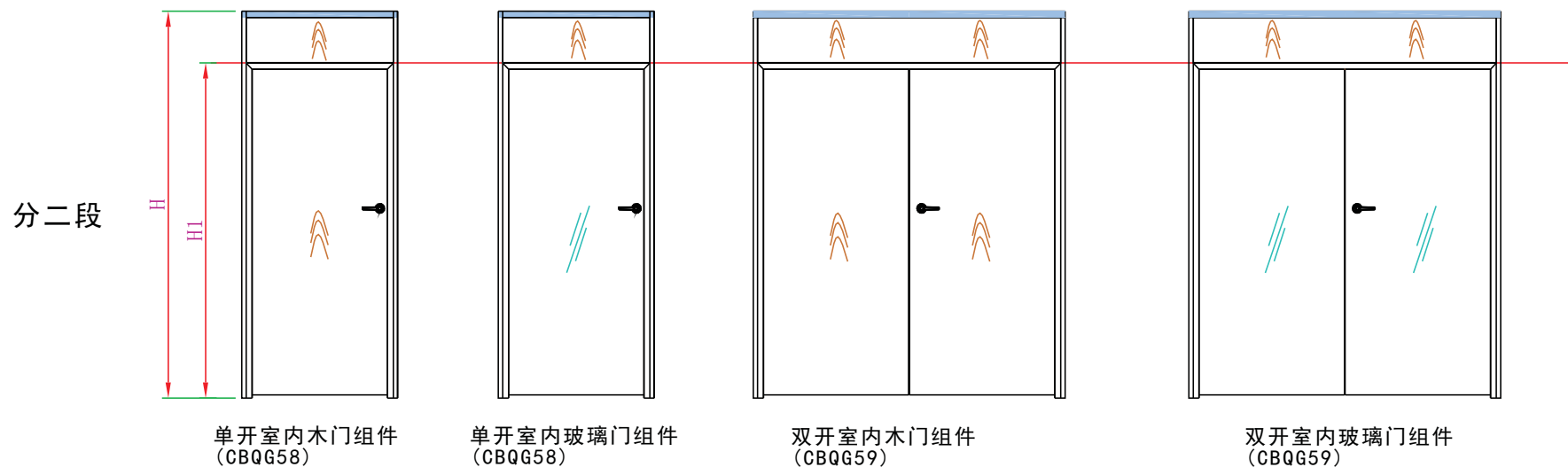

----连接方式

L转角柜

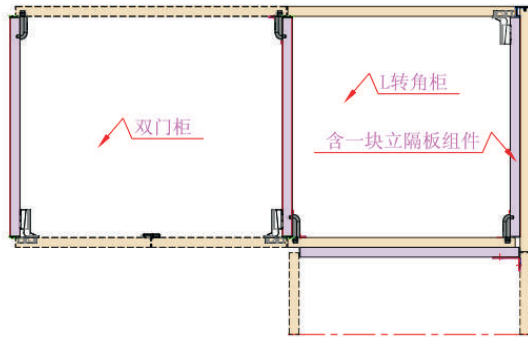

L内转角柜

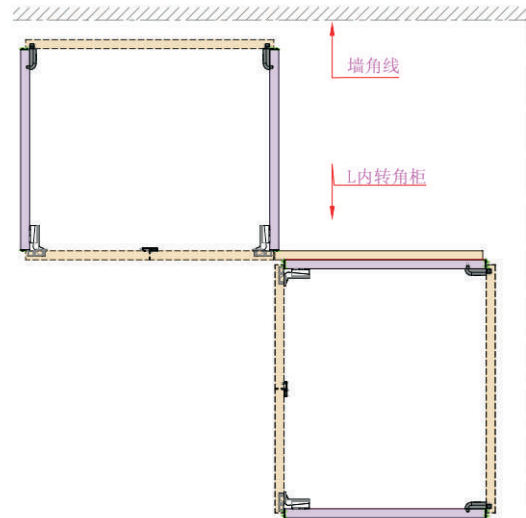

十字连接

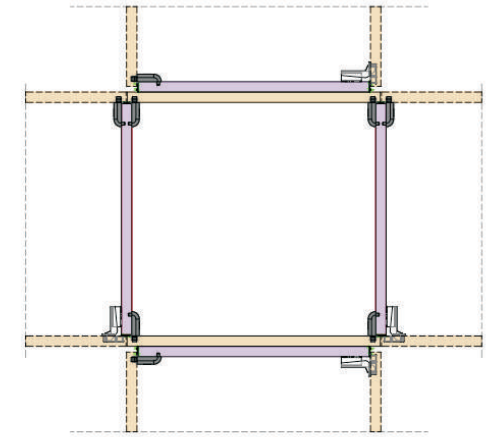

T连接

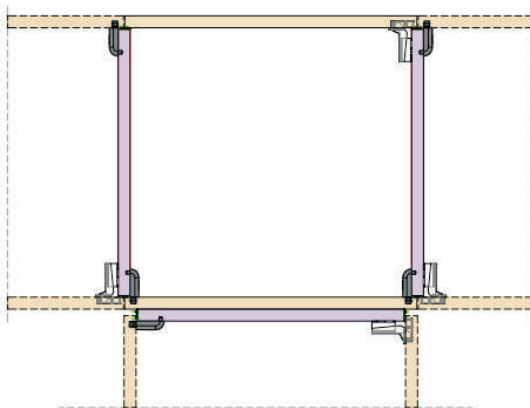

双背板柜T连接

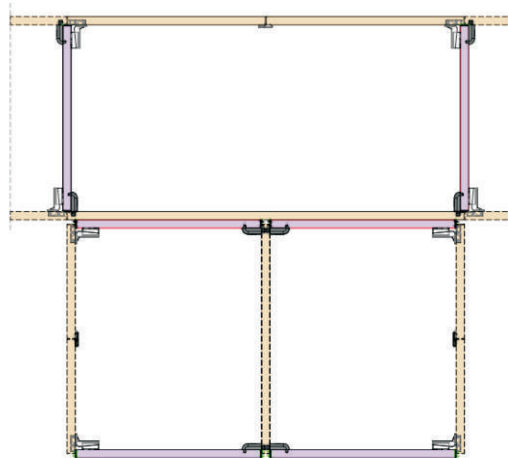

Z连接

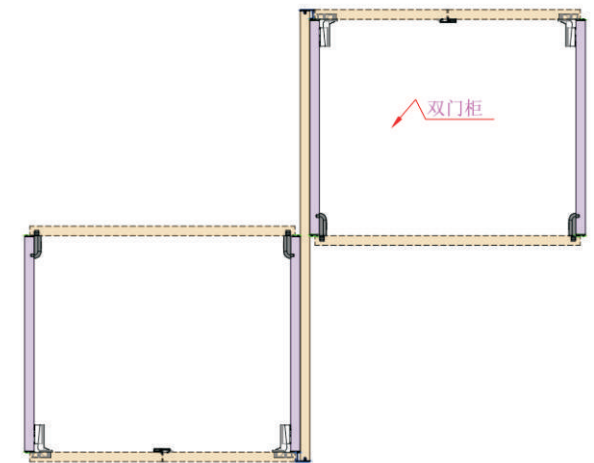

单背板柜

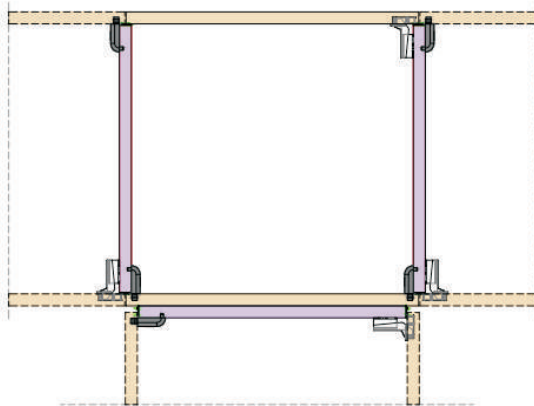

双背板柜

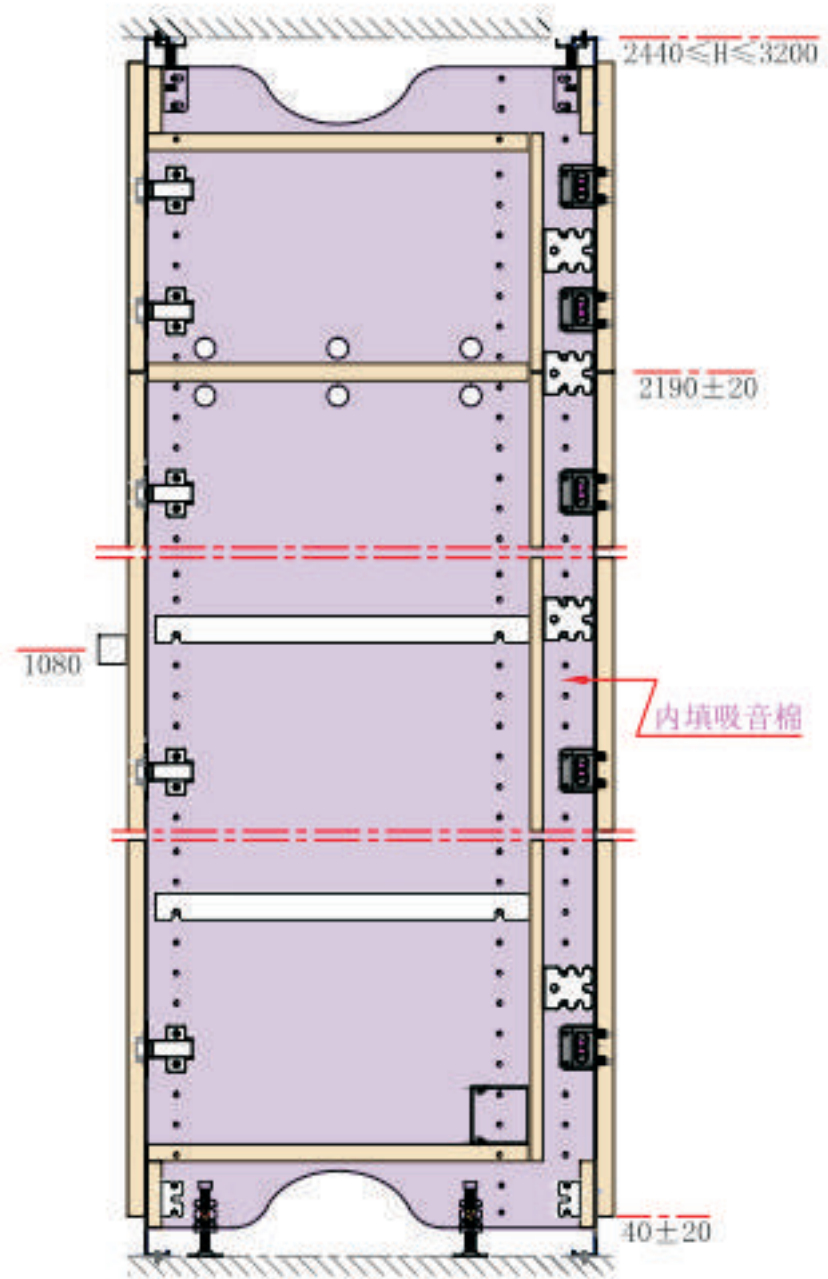
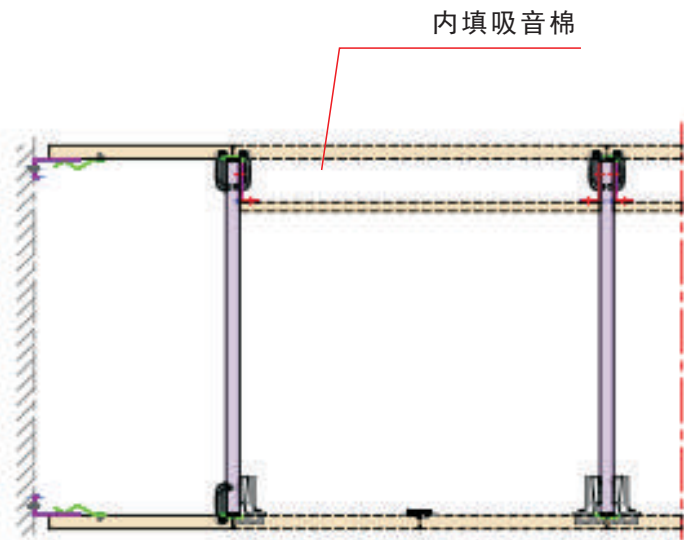

----应用方案展示

酷壁与106连接方案展示

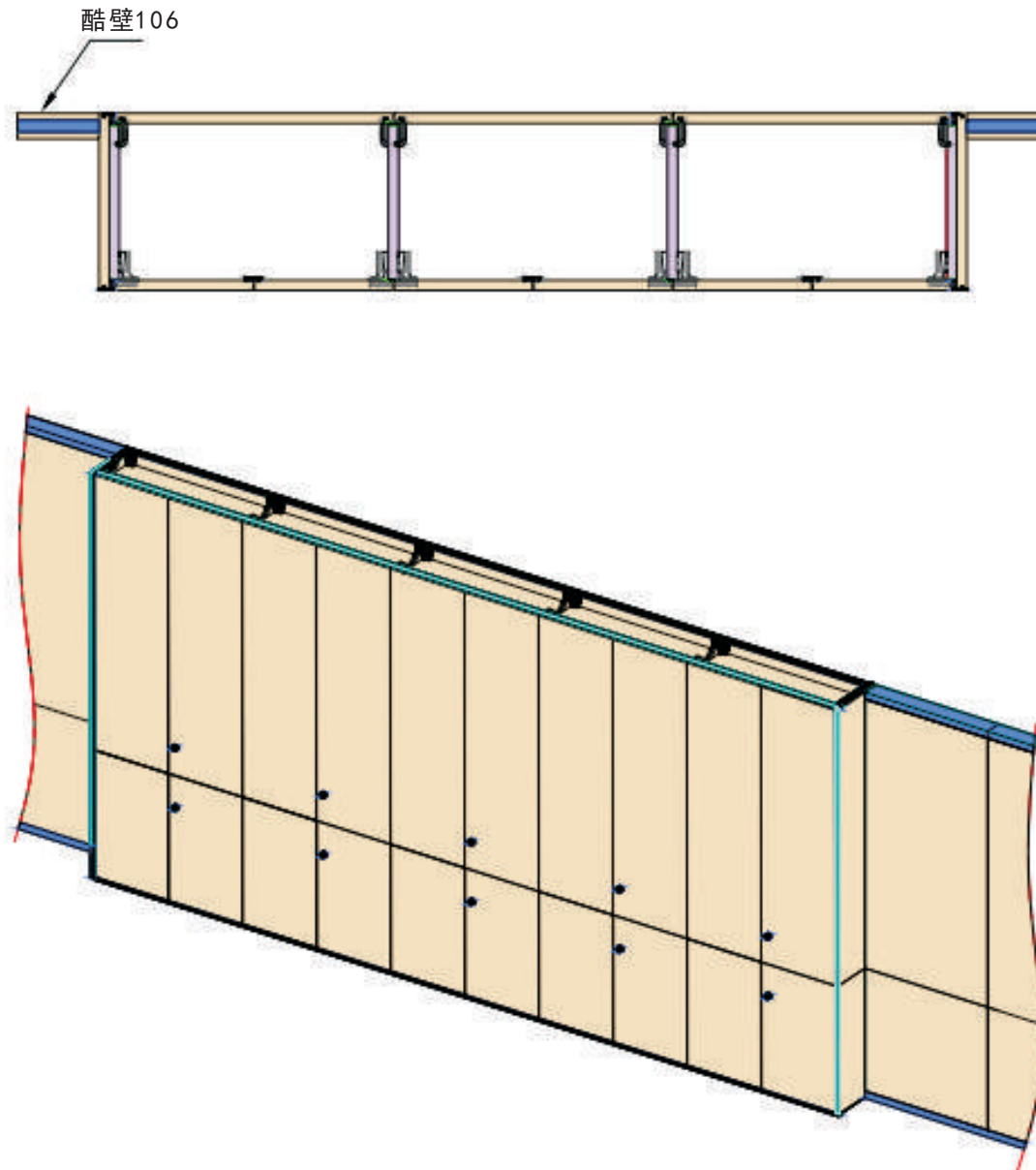

高隔墙柜转角连接展示

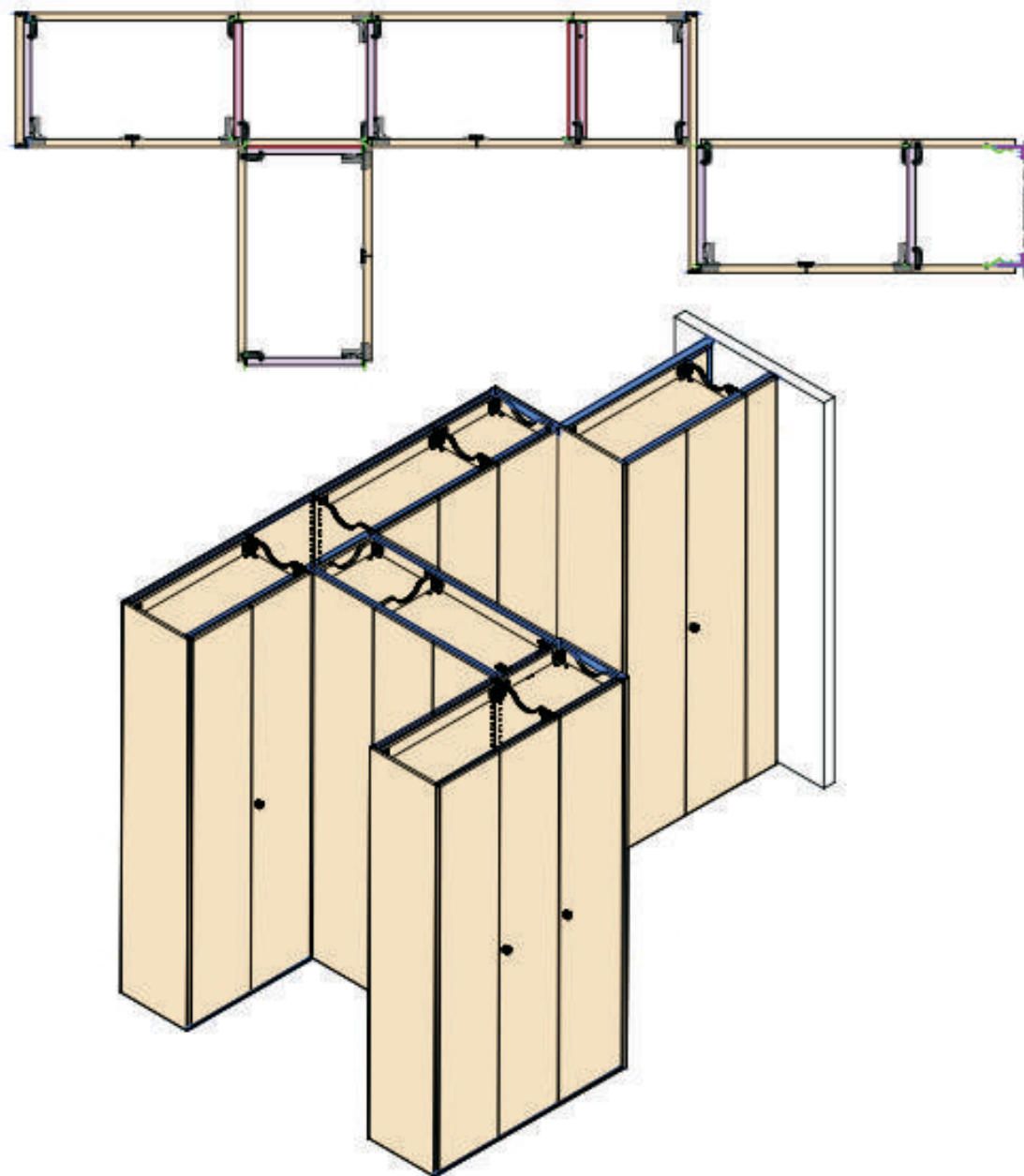

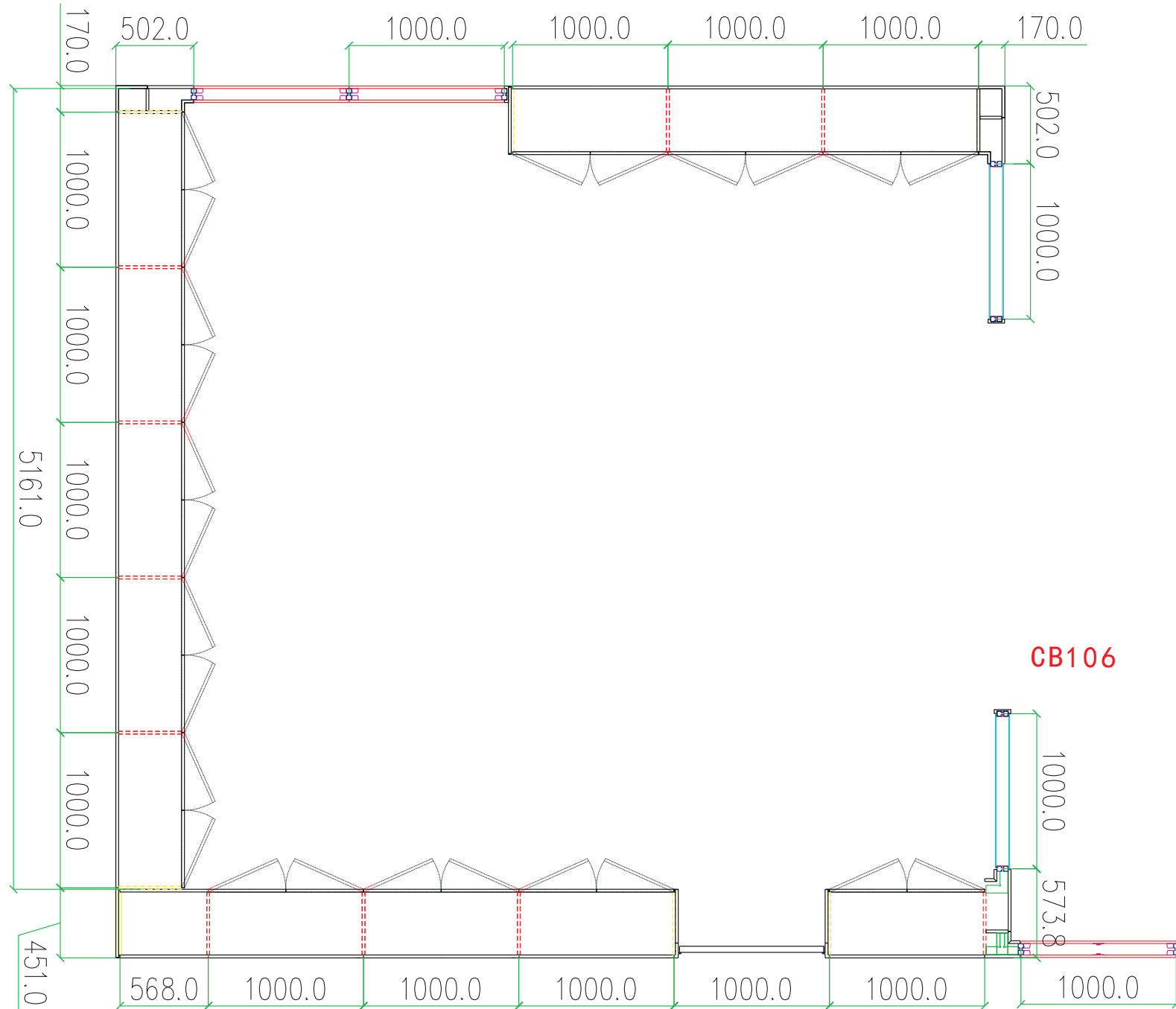

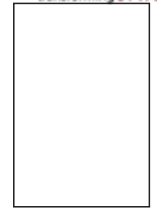

VID-030S

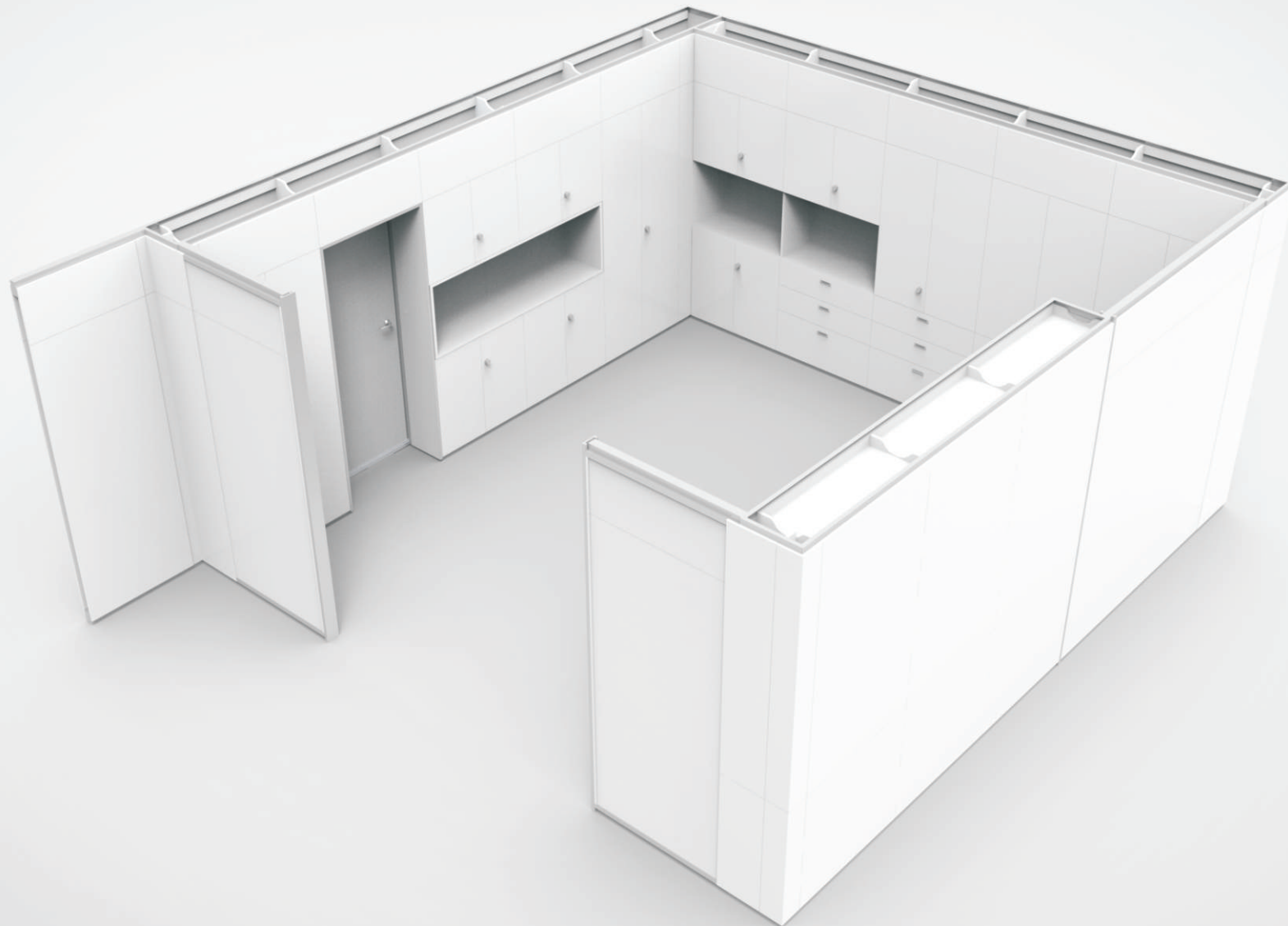

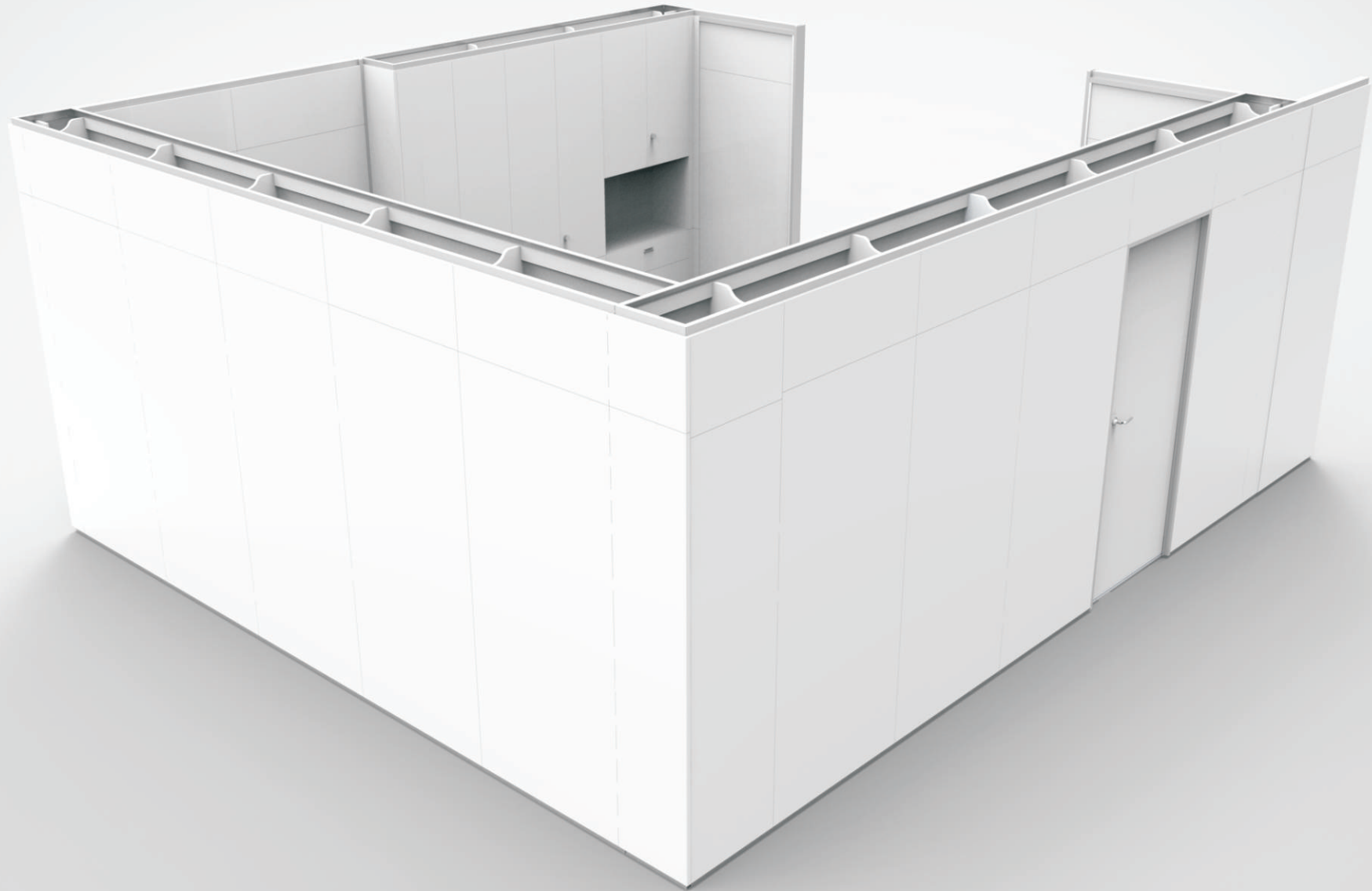

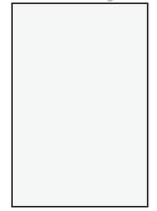

VID-009S

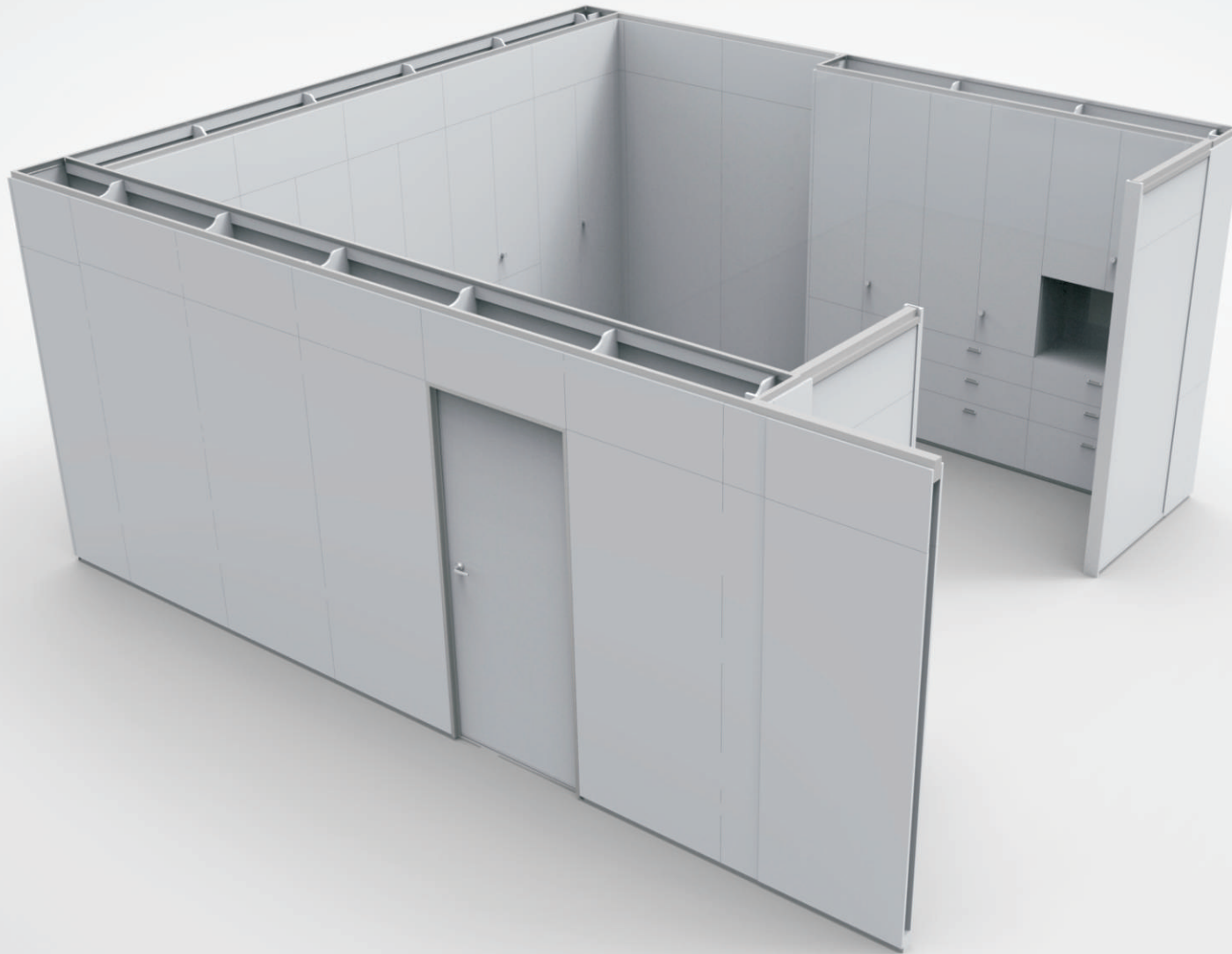

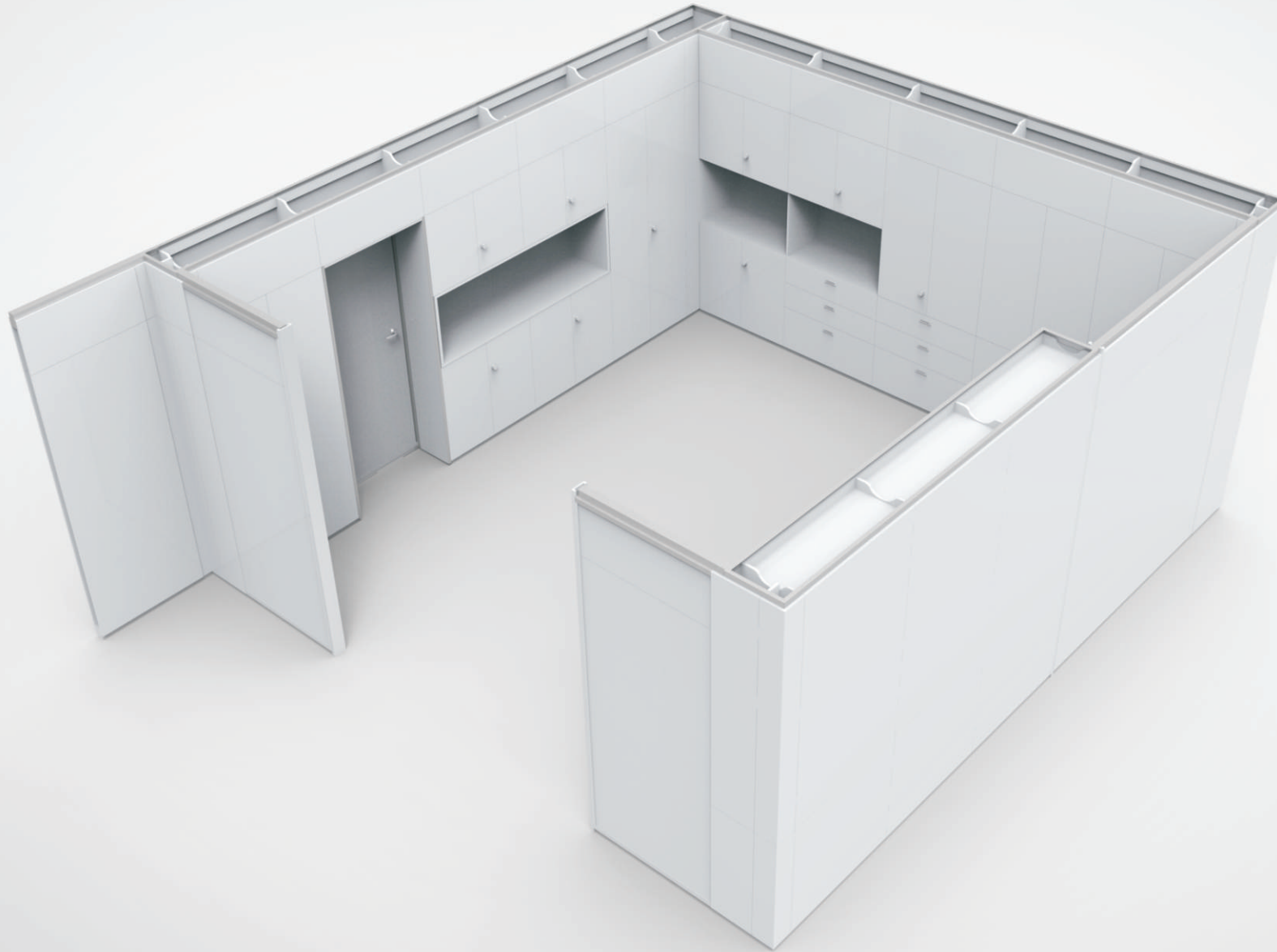



V-44

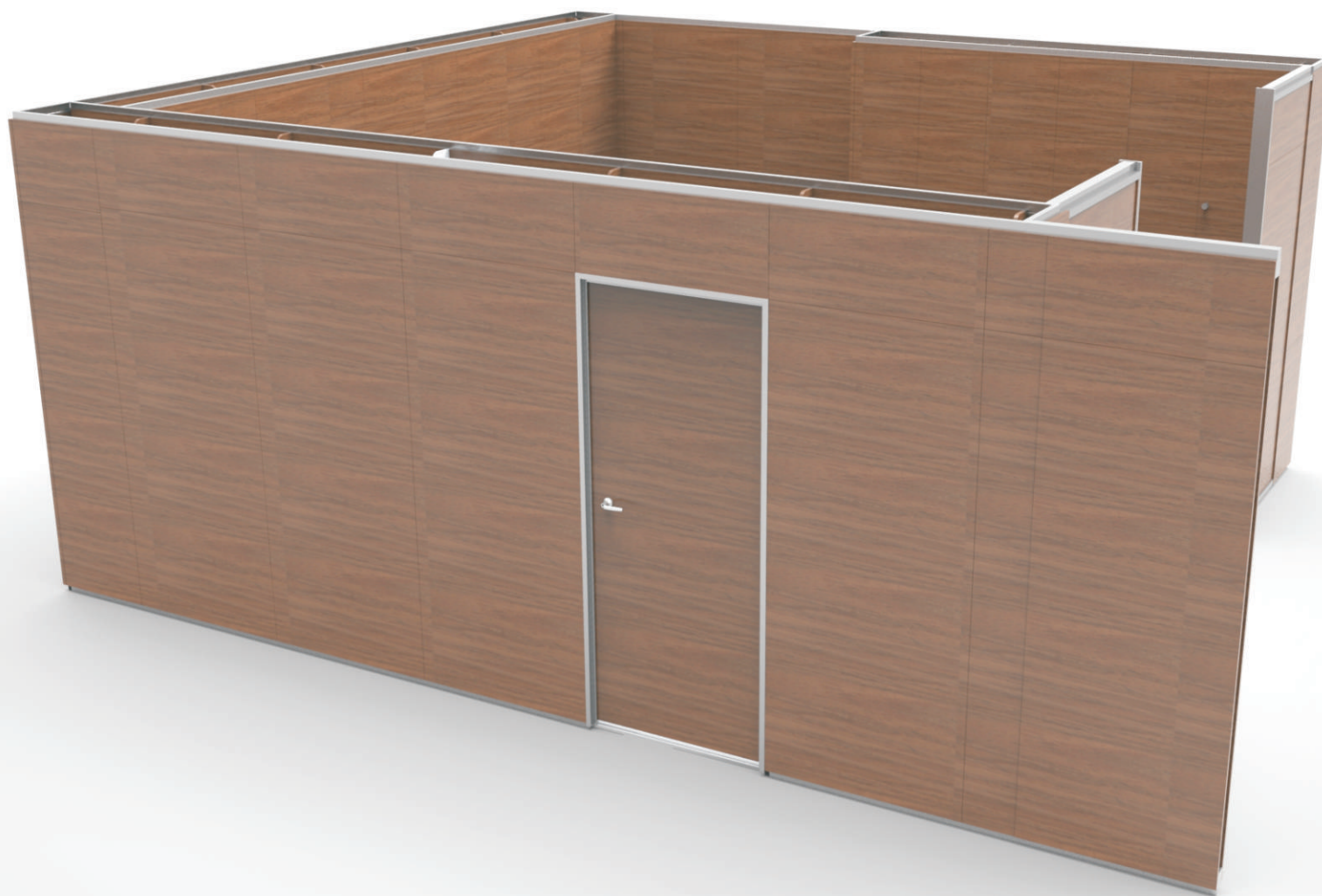

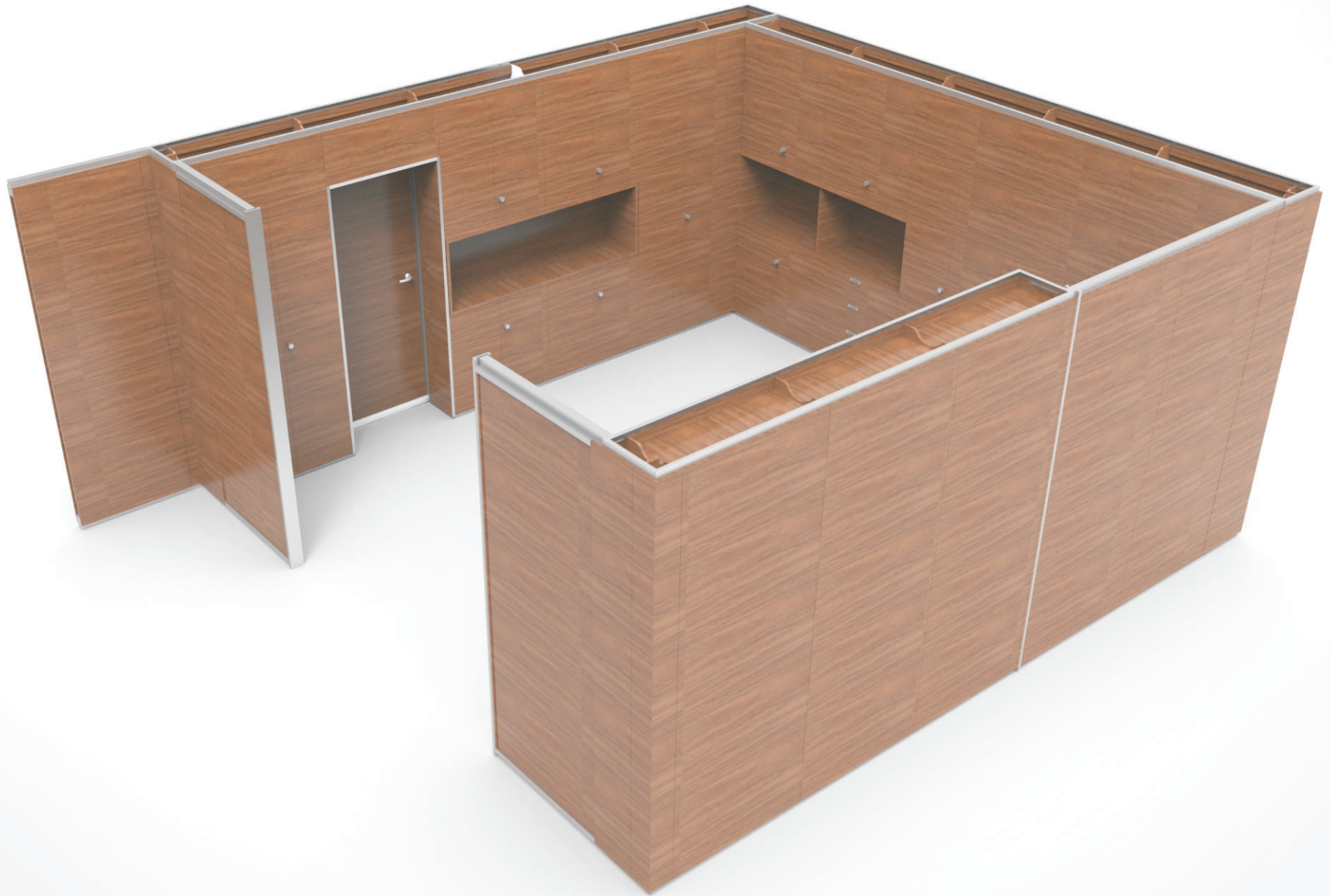

等统一用时尚灰MFC板(VID-009S)

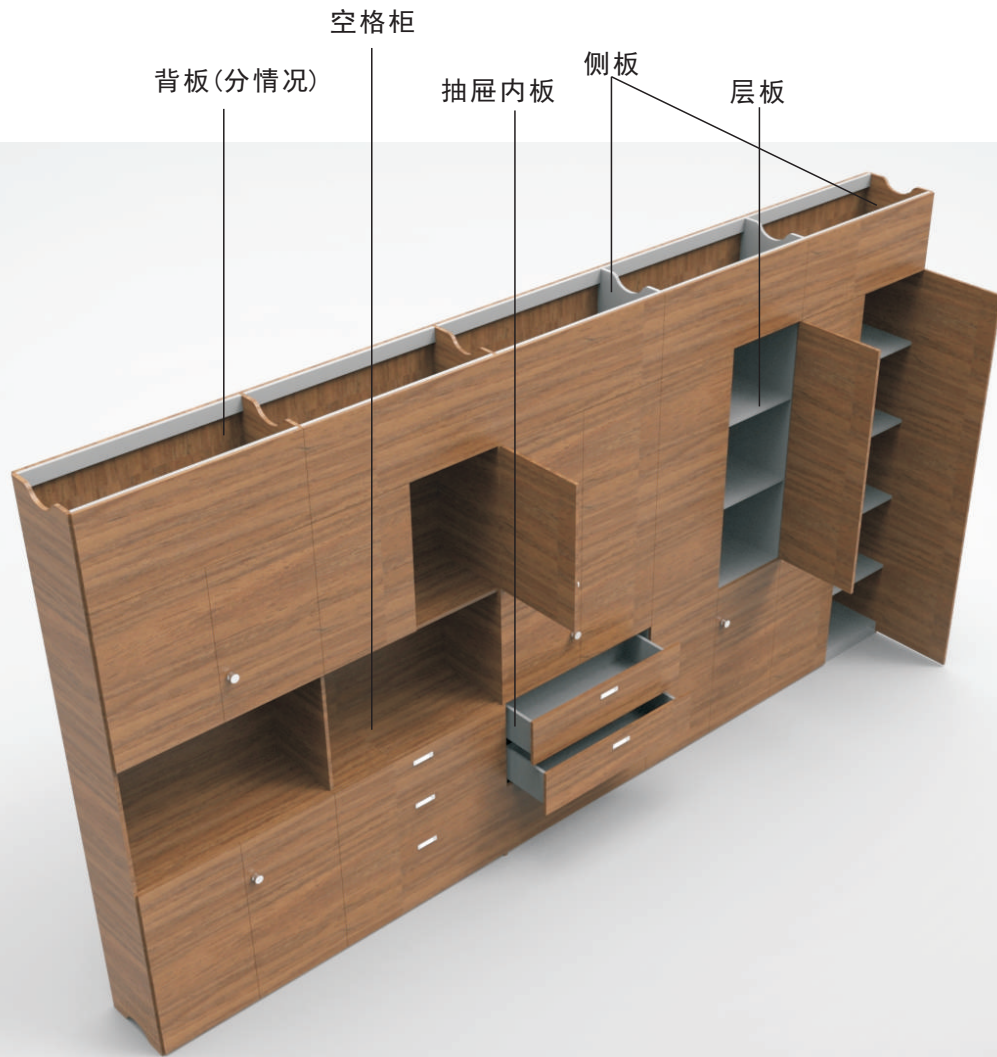

靠墙时



不靠墙时



Cube High Partition & Wall Storage Material Styles

Glass

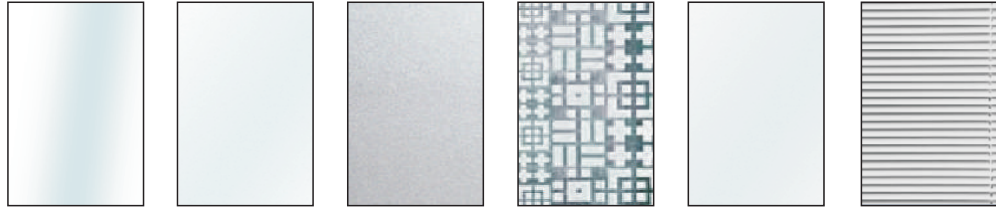

MFC



VID-030S

VID-009S

VID-021S

VID-004S

SC-M02

UV Cover

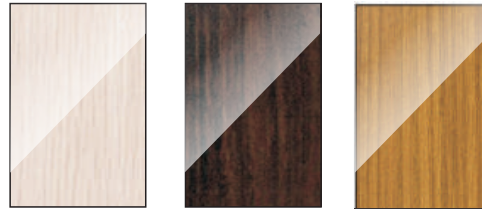

VID-004S

VID-041S

VID-021S

Wood

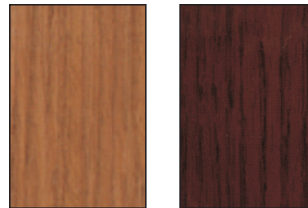

V-44

V-30

Fabric Velvet

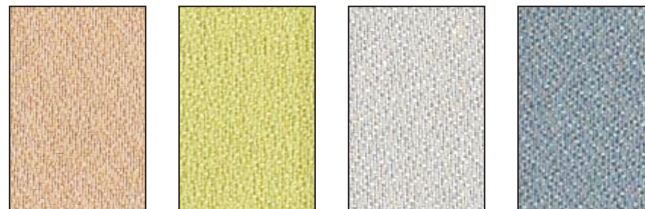

TT-023

TT-032

TT-027

TT-005